

Client Signature: \_\_\_\_\_ Date: \_\_\_\_\_

Sheet No. \_\_\_\_\_  
 Date: 12/1/14  
 Scale: NTS  
 Designer: K.GRAY  
 Revisions:

**Notice:**  
 This drawing, including the specifications, concepts, designs and arrangements represented hereby or incorporated in it, is and shall remain the property of Office Environments, Inc. It shall not be copied, disclosed to third parties, used to perform or complete this project by others, or used on any project other than the specific project for which it has been prepared. Field dimensions must be verified prior to installation.

UF HEAVENER HALL  
 CLASSROOM 210 - LAYOUT 1  
 PROPOSAL #102459  
[www.officeenvironments.com](http://www.officeenvironments.com)

 office environments  
 1801 Hermitage Blvd  
 Suite 170  
 Tallahassee, FL 32308

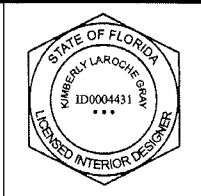

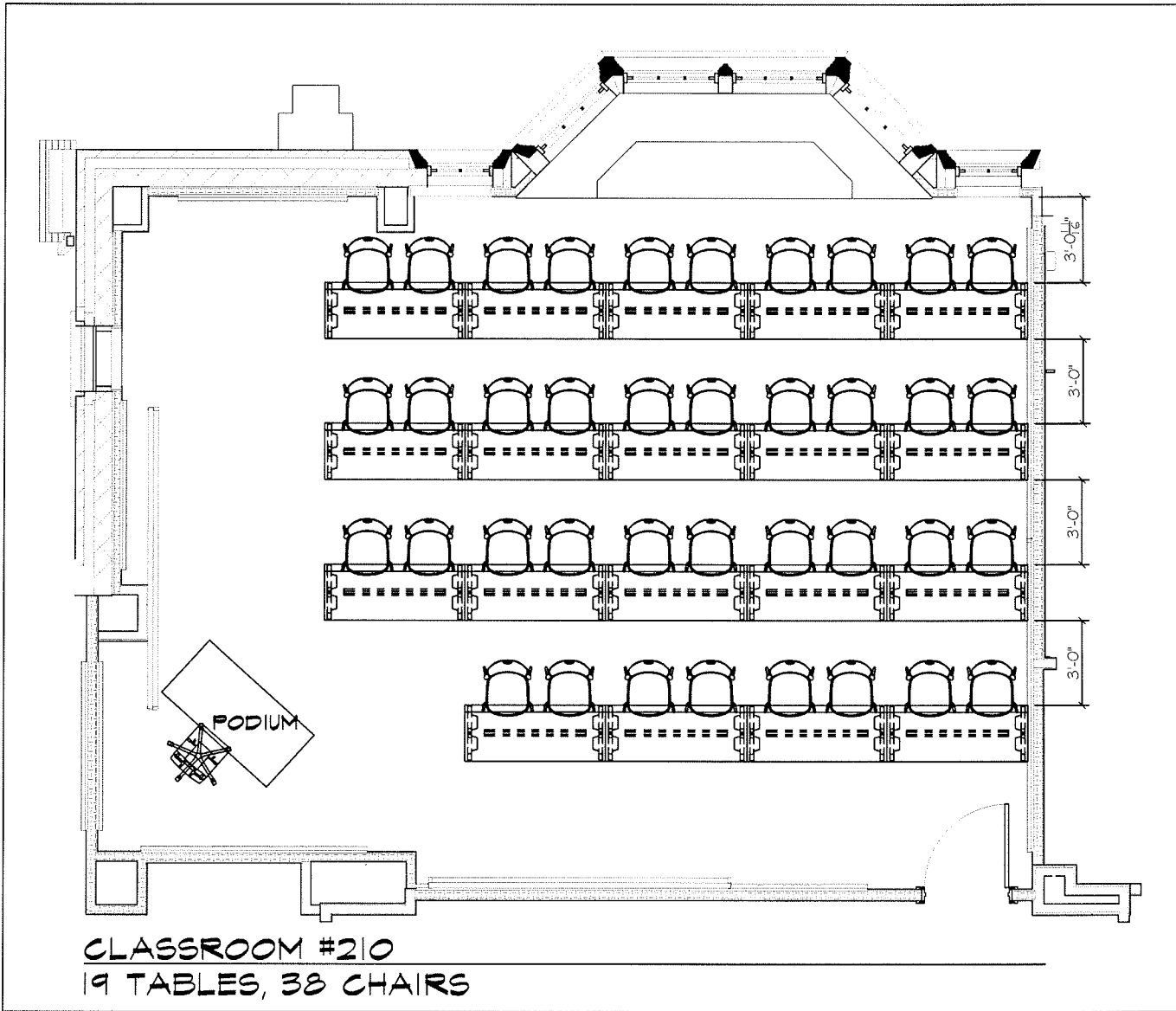

Client Signature:

Date:

Sheet No.

Date: 12/1/14

Scale: NTS

Designer: K.GRAY

Revisions:

File Path: Dec 01, 2014 - 10: 05am E:\UF HEAVENER HALL\New Floorplans 1-16-15\FINAL DRAWINGS\2nd Floor Classrom Layouts.dwg

Notice:  
This drawing, including the specifications, concepts, designs and arrangements represented thereby or incorporated in it, is and shall remain the property of Office Environments, Inc. It shall not be copied, disclosed to third parties, used to perform or complete the project by others, or used on any project other than the specific project for which it has been prepared. Field dimensions must be verified prior to installation.

UF HEAVENER HALL  
CLASSROOM 210 - LAYOUT 2  
PROPOSAL #102459

[www.officenvironments.com](http://www.officenvironments.com)



office environments

1801 Hermitage Blvd  
Suite 170  
Tallahassee, FL 32308

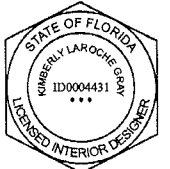

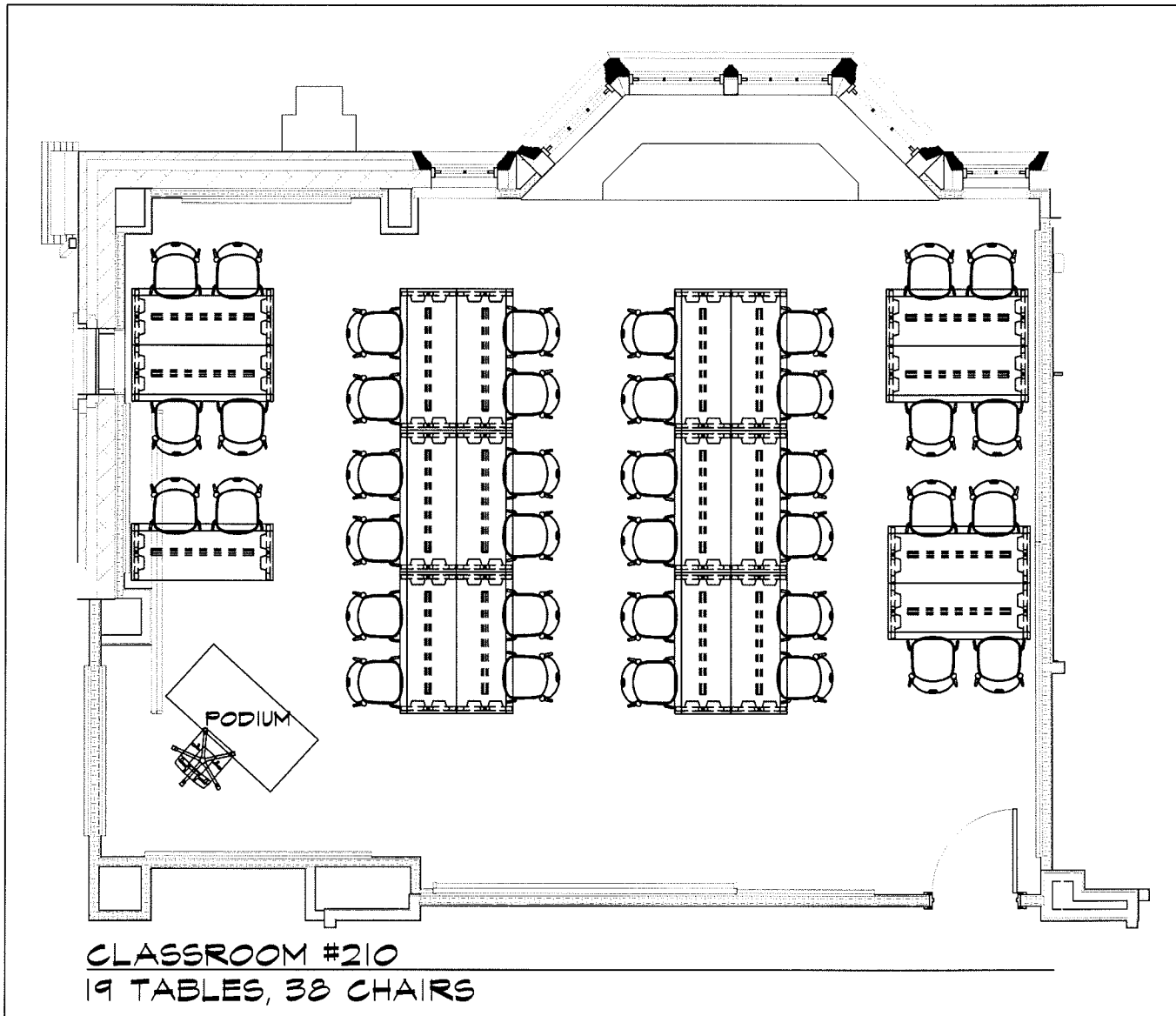

Client Signature: \_\_\_\_\_ Date: \_\_\_\_\_

Sheet No. \_\_\_\_\_

Date: 12/1/14

Scale: NTS

Designer: K.GRAY

Revisions:

File Path: Dec 01, 2014 - 10: 05am E:\UF HEAVENER HALL\New Floorplans 1-10-BYPINAL DRAWINGS\2nd Floor Classroom Layouts.dwg

Notice:  
 This drawing, including the specifications, concepts, designs and arrangements represented thereby or incorporated in it, is and shall remain the property of Office Environments, Inc. It shall not be copied, disclosed to third parties, used to perform or complete this project by others, or used on any project other than the specific project for which it has been prepared. Field dimensions must be verified prior to installation.

UF HEAVENER HALL  
 CLASSROOM 210 - LAYOUT 3  
 PROPOSAL #102459  
[www.officenvironments.com](http://www.officenvironments.com)



office environments

1801 Hermitage Blvd  
 Suite 170  
 Tallahassee, FL 32308

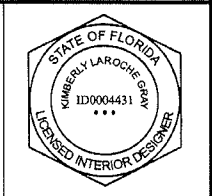

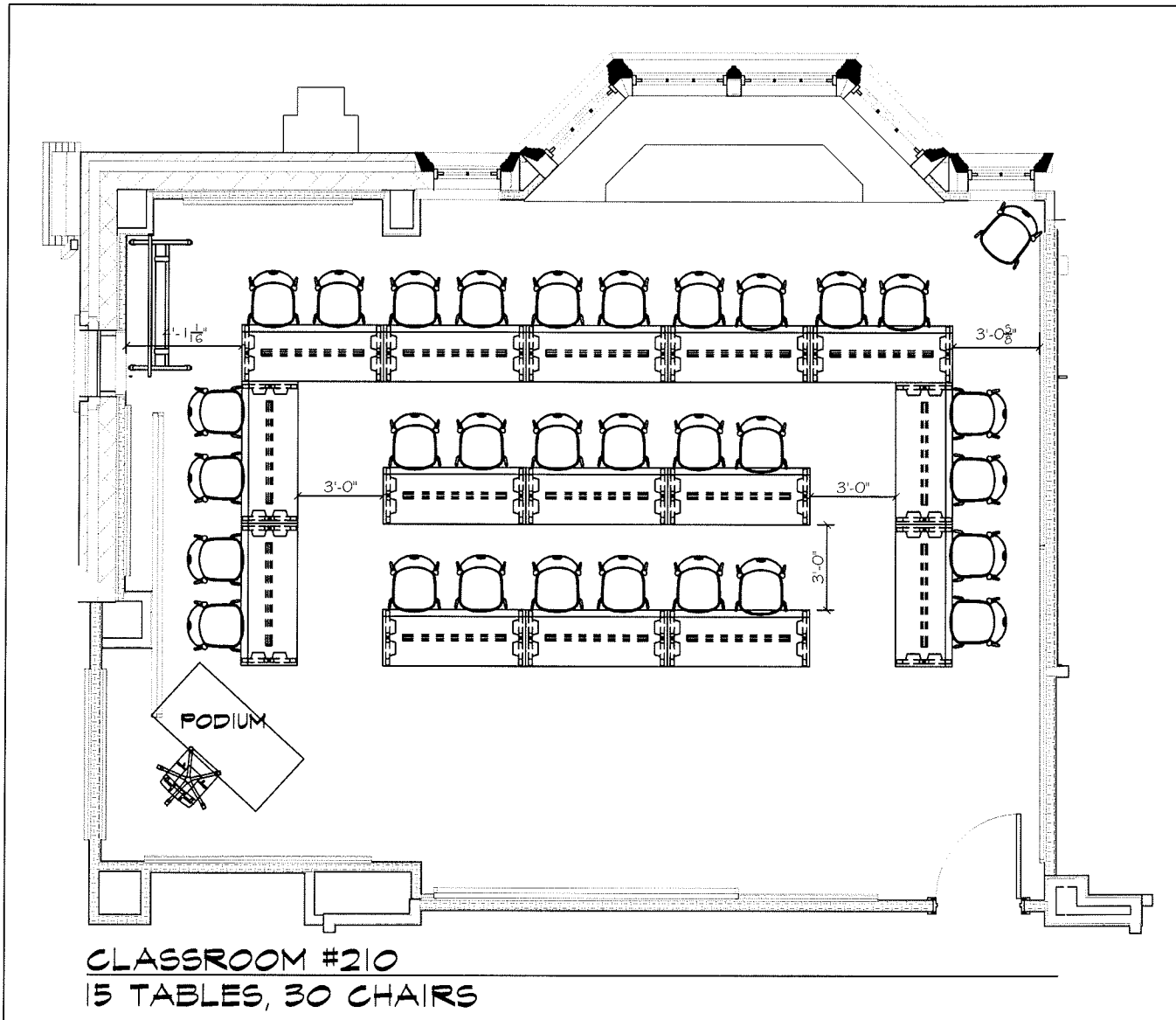

Client Signature:

Date:

Sheet No.

Date: 12/1/14

Scale: NTS

Designer: K.GRAY

Revisions:

File Path: Dec 01 2014 - 10: 05am E:\UF HEAVENER HALL\New Floorplans 1-10-15\FINAL DRAWINGS\2nd Floor\Classroom Layouts.dwg

Notice:  
 This drawing, including the specifications, concepts, designs and arrangements represented thereby or incorporated in it, is and shall remain the property of Office Environments, Inc. It shall not be copied, disclosed to third parties, used to perform or complete the project by others, or used on any project other than the specific project for which it has been prepared. Field dimensions must be verified prior to installation.

UF HEAVENER HALL  
 CLASSROOM 210 - LAYOUT 4  
 PROPOSAL #102459

[www.officeenvironments.com](http://www.officeenvironments.com)



1801 Hermitage Blvd  
 Suite 170  
 Tallahassee, FL 32308

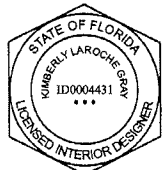

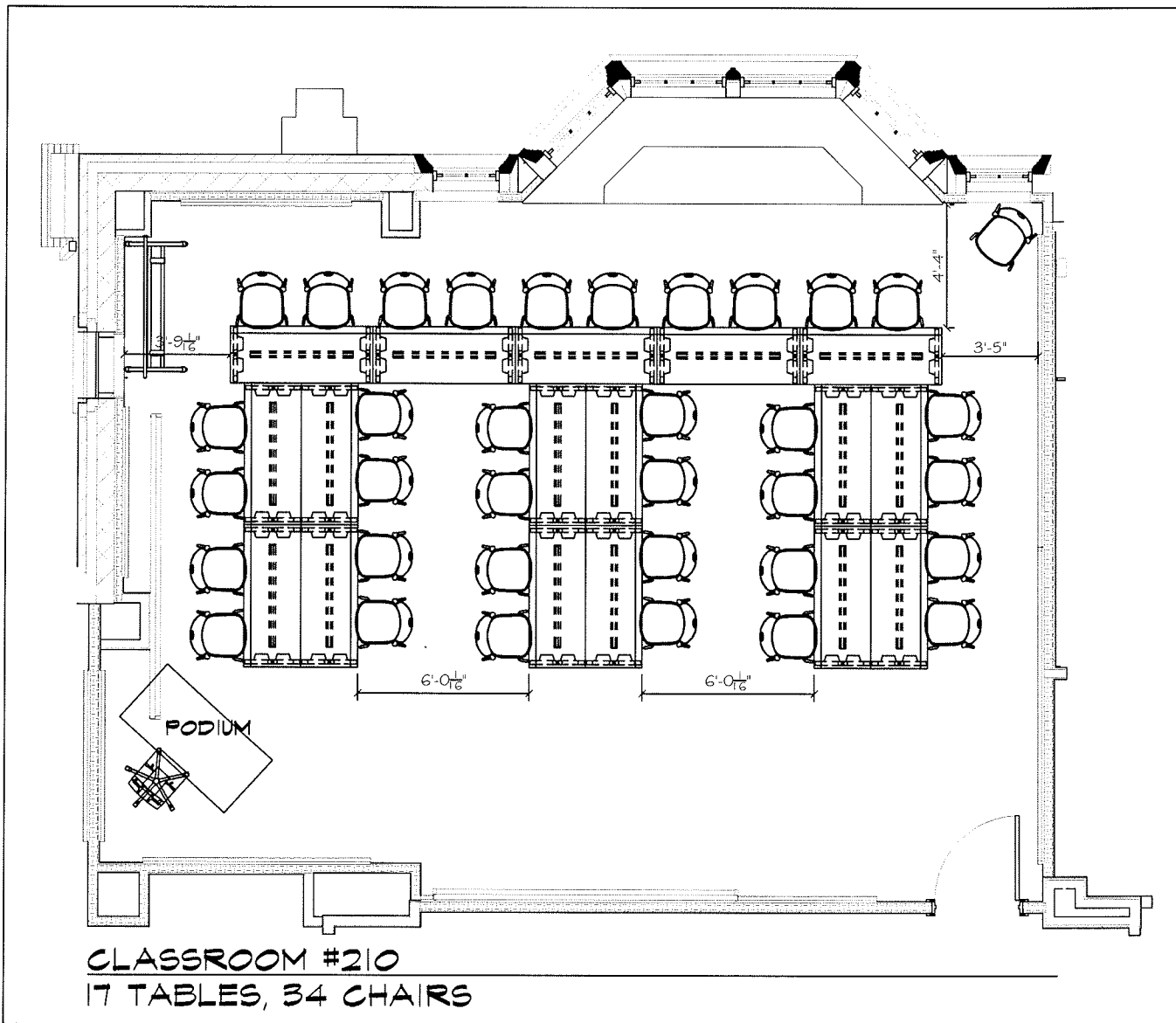

Client Signature:

Date:

Sheet No.

Date: 12/1/2014

Scale: NTS

Designer: K.GRAY

Revisions:

File Path: Dec 01 2014 - 10: 05am E:\UF HEAVENER HALL\New Floorplans I-16-15\FINAL DRAWINGS\2nd Floor Classrom Layouts.dwg

Notice:  
This drawing, including the specifications, concepts, designs and arrangements represented thereby or incorporated in it, is and shall remain the property of Office Environments, Inc. It shall not be copied, disclosed to third parties, used to perform or complete the project by others, or used on any project other than the specific project for which it has been prepared. Field dimensions must be verified prior to installation.

UF HEAVENER HALL  
CLASSROOM 210 - LAYOUT 5  
PROPOSAL #102459

[www.officeenvironments.com](http://www.officeenvironments.com)



office environments

1801 Hermitage Blvd  
Suite 170  
Tallahassee, FL 32308



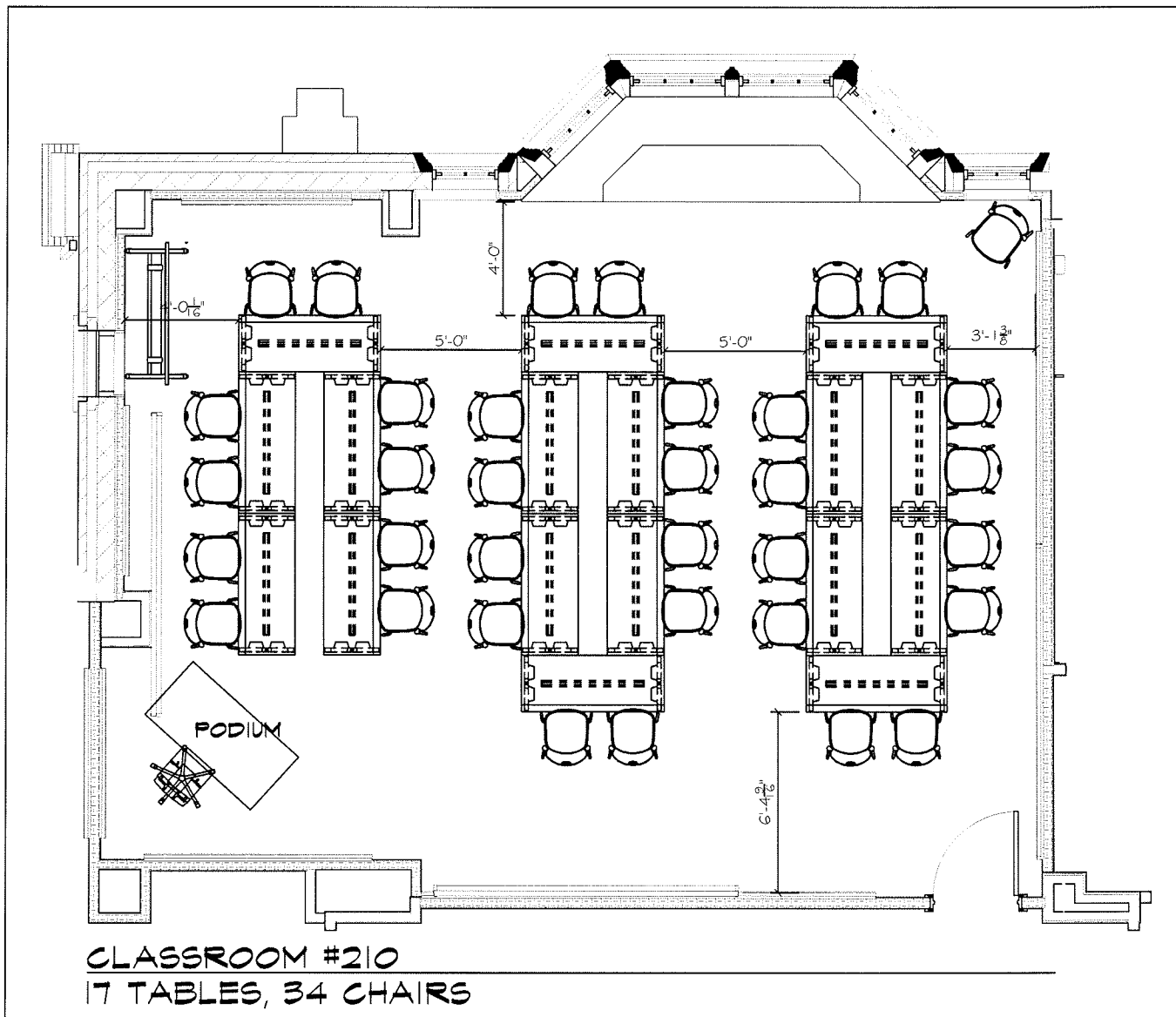

Client Signature:

Date:

Sheet No.

Date: 12/1/14

Scale: NTS

Designer: K.GRAY

Revisions:

Notice:  
 This drawing, including the specifications, concepts, designs and arrangements represented thereby or incorporated in it, is and shall remain the property of Office Environments, Inc. It shall not be copied, disclosed to third parties, used to perform or complete the project by others, or used on any project other than the specific project for which it has been prepared. Field dimensions must be verified prior to installation.

UF HEAVENER HALL  
 CLASSROOM 210 - LAYOUT 6  
 PROPOSAL #102459

[www.officeenvironments.com](http://www.officeenvironments.com)



1801 Hermitage Blvd  
 Suite 170  
 Tallahassee, FL 32308

